

- ### NOTES
- DUCTS TO BE SOUNDLINED 3' UPSTREAM AND DOWNSTREAM OF PINCH BOXES.
 - FLEX DUCT LENGTH NOT TO EXCEED FIVE FEET.
 - COMPLY WITH IMC SECTION 5.10 DUCT CONSTRUCTION AND MANUFACTURING.
 - ALL SPACES TO BE SERVED BY AV BOXES OF A SIZE TO MATCH INCOMING SUPPLY DUCT.
 - EXHAUST DIFFUSERS IN EACH ROOM SHALL HAVE SAME CFM AS TOTAL OF SUPPLY DIFFUSERS, EXCEPT WHERE NOTED. ALL EXHAUST DIFFUSERS SHALL BE MARK RG-PA, PG-PB, RG-PC, RG-PD, OR RG-PE AND SELECTED SO THAT NECK SIZE MATCHES THE DUCT SIZE SHOWN ON THE DRAWING.
 - SEE DETAILS FOR MANUAL VOLUME DAMPER IN THE BRANCH DUCT SERVING EACH SUPPLY OR EXHAUST DIFFUSER.

- ### KEY NOTES
- 101-FTR-14, 15, 16, 17 & 18, REFER TO MP111.
 - 101-FTR-1, 2, 3 & 4, REFER TO MP111.
 - 16x14 CAPPED FOR FUTURE FUME HOODS (2 AT 600CFM EA) C/W BD.

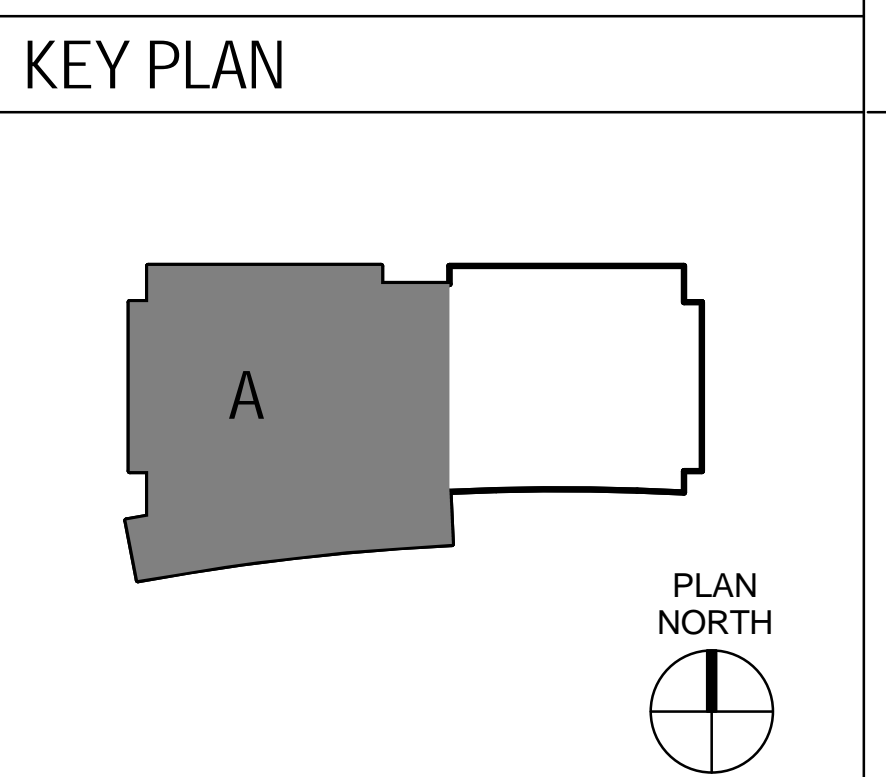

CONSTRUCTION DOCUMENT 2
FULLY SPRINKLERED

Project Number VAF 663-405B	Office of Construction and Facilities Management
Building Number B101 Mental Health Services	
Drawing Number MH111	Department of Veterans Affairs
Volume 2b	

CONSULTANTS:

Stantec Consulting
100 California Street, Suite 1000
San Francisco, CA 94111
T: 415.882.9500
F: 415.882.9523

ARCHITECT

STANTEC | THE DESIGN PARTNERSHIP

Drawing Title
MH&R - LEVEL 1, SECTOR A HVAC FLOOR PLAN

Drawing Scale
1/8" = 1'-0"

Approved: Project Director

Project Title
Building 101 Mental Health Services VAPSHCS Seattle
Division - Phase 2
MENTAL HEALTH AND RESEARCH BUILDING

Location
1660 South Columbian Way, Seattle, WA 98105

Date
JUNE 05, 2013

Checked
Author

Drawn
Author

AMENDMENT A00004 07.14.2014
BID DOCUMENTS 05.30.2014
CONSTRUCTION DOCUMENT CD2 06.05.2013

7/11/2014 6:58:28 PM
one eighth inch = one foot
one quarter inch = one foot
three eighth inch = one foot
one half inch = one foot
three quarter inch = one foot
one inch = one foot
one and one half inches = one foot
three inches = one foot