

three inches = one foot
 one and one half inches = one foot
 one inch = one foot
 three quarter inch = one foot
 one half inch = one foot
 three eighth inch = one foot
 one quarter inch = one foot
 one eighth inch = one foot



- LEGEND**
- FIRE ALARM CONTROL PANEL
 - FIRE ALARM REMOTE POWER SUPPLY
 - FIRE SYSTEM ANNUCIATOR
 - MANUAL PULL STATION
 - SMOKE DETECTOR
 - HEAT DETECTOR
 - DUCT SMOKE DETECTOR
 - FIRE/SMOKE DAMPER
 - SPRINKLER SUPERVISORY TAMPER SWITCH
 - SPRINKLER WATERFLOW SWITCH
 - SPRINKLER LOW AIR PRESSURE SWITCH
 - CEILING MOUNTED SPEAKER STROBE
 - WALL MOUNTED SPEAKER/STROBE
 - COMBINED FIRE SPRINKLER/STANDPIPE RISER
 - STANDPIPE RISER

- NOTES**
1. THE FLOOR IS A BUSINESS OCCUPANCY
 2. THE BUILDING IS PROVIDED WITH COMPLETE AUTOMATIC SPRINKLER PROTECTION
 3. THE FLOOR IS A LIGHT HAZARD SPRINKLER CLASSIFICATION
 4. LOCATIONS OF NOTIFICATION APPLIANCE BOOSTER PANELS SHALL BE PROVIDED WITH AUTOMATIC SMOKE DETECTOR PROTECTION AS DEFINED IN NFPA 72

- KEY NOTES**
- 1 NOT USED
 - 2 NOT USED
 - 3 PROVIDE DUCT DETECTION FOR FAN SHUTDOWN FOR GROUND LEVEL AIR HANDLING UNITS
 - NOT USED

1 GROUND LEVEL LAYOUT
 1/16" = 1'-0"

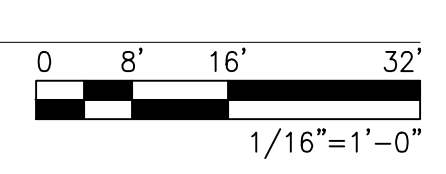

KEY PLAN

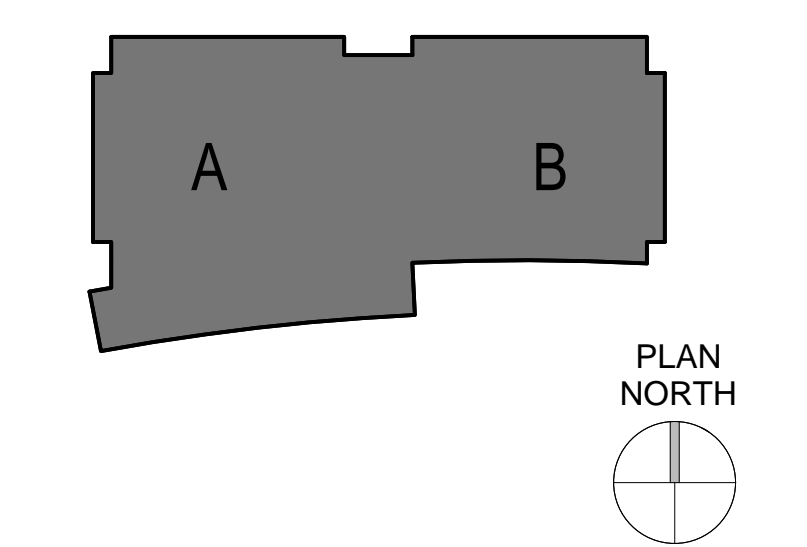

CONSTRUCTION DOCUMENT 2
 FULLY SPRINKLERED

AMENDMENT A00004	07.14.2014
BID DOCUMENTS	05.30.2014
CONSTRUCTION DOCUMENT CD2	06.05.2013

CONSULTANTS:

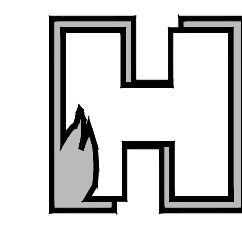

Hughes Associates, Inc.
 Fire Science and Engineering
 2551 San Ramon Valley Blvd Suite 209
 San Ramon, CA 94583
 Phone: (925) 314-7910
 Fax: (925) 314-9750
 HAI Project No. 10KK0022.003



ARCHITECT



STANTEC | THE DESIGN PARTNERSHIP

Drawing Title	
Ground Level Fire Alarm Layout	
Drawing Scale	
1/16" = 1'-0"	
Approved: Project Director	

Project Title		
Building 101 Mental Health Services VAPSHCS Seattle Division - Phase 2 MENTAL HEALTH AND RESEARCH BUILDING		
Location		
1650 South Columbian Way, Seattle, WA 98105		
Date	Checked	Drawn
JUNE 05, 2013	-	-

Project Number	VAH 663-405B
Building Number	B101 Mental Health Services
Drawing Number	FA101 Vol. 2c

Office of Construction and Facilities Management
 Department of Veterans Affairs